

Locality Diagram (Not to Scale)

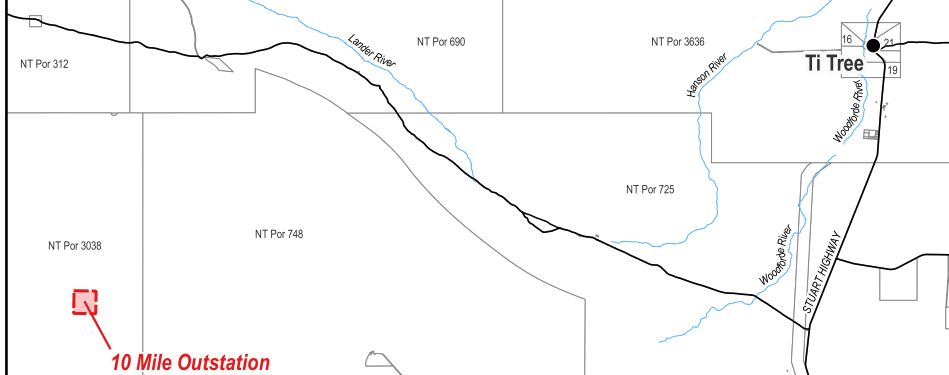

The Interim Alcohol Protected Area is centred around a coordinate (230036m E and 7513155m N) based on MGA94 Zone 53 and has a radius of 1000m.

Coordinates have been derived from the Northern Territory Integrated Land Information System (ILIS) and are approximate.

The boundaries of the subject Interim Alcohol Protected Area are declared in accordance with Section 170A of the *Liquor Act 2019*.

Cadastral Date: 20/07/2023
Imagery Date: 2010

Legend

- Aboriginal Community
- Track
- Cadastre
- Interim Alcohol Protected Area

Interim Alcohol Protected Area 10 Mile Outstation Family Outstation

CERTIFIED CORRECT:

Dee Dee

DELEGATE OF THE SURVEYOR-GENERAL

21/07/2023
DATE

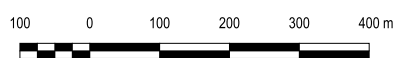

S2023/111