

IN ACCORDANCE WITH NCC VOLUME 2 (SECTION P3.10.1), THIS PRODUCT SATISFIES PERFORMANCE REQUIREMENT P2.1.1 FOR CONSTRUCTION IN A HIGH WIND AREA.

Product Name SHEET 1 OF 2
 FENCING FOR CYCLONIC REGIONS: NEETASCREEN & SPANSCREEN

Product Description
 FENCE PANEL: 0.35 BMT, G550 AM125 & COLORBOND
 FENCE POST: 0.8 BMT, G550 Z275 COLORBOND
 FENCE POST: 1.6 OR 2.5 BMT SHS GRADE 350LO GALVANISED.
 FENCE RAIL: 0.8 BMT, G550 Z 275 COLORBOND

Manufacturer's Name
 Lysaght
 BlueScope Steel Limited
 A.B.N. 16 000 011 058
 Trading as Lysaght



Design Criteria
 1. FENCE CONFIGURATIONS ARE FOR TERRAIN CATEGORY 2, 2.5, & 3 IN WIND REGION 'C'. $V_R = 61 \times F_c = 61 \times 1.05 = 64.1$ m/sec, CORRESPONDING TO AN AVERAGE RECURRENCE INTERVAL OF 200 YEARS.
 2. WIND LOADING ARE DERIVED FROM AS/NZS 1170.2: 2011 STRUCTURAL DESIGN ACTIONS PART 2: WIND ACTIONS BASED ON THE FOLLOWING PARAMETERS:

a)

HEIGHT (mm)	TERRAIN / HEIGHT MULTIPLIER (Mz, cat)		
	TERRAIN CAT 2	TERRAIN CAT 2.5	TERRAIN CAT 3
≤1800	0.91	0.87	0.83

b)

SHIELDING MULTIPLIER Ms	TERRAIN CAT 2	TERRAIN CAT 2.5	TERRAIN CAT 3
		0.95	0.85

c) $M_t = 1.0$; TOPOGRAPHIC MULTIPLIER.
 d) $M_d = 1.0$; WIND DIRECTIONAL MULTIPLIER.
 REFER TO AS/NZS 1170.2 - 2011 FOR DESIGN OF FENCES INSTALLED NEAR RIDGES, HILLS OR ESCARPMENTS, OR WHERE SHIELDING CONDITION VARY.
 3. $C_{pn} = 1.2$ EXCEPT FOR TAPERED ENDS, REF. TO SECTION D2 - AS/NZS 1170.2:2011 STRUCTURAL DESIGN ACTIONS PART 2: WIND ACTIONS.
 4. IMPORTANCE LEVEL 1, WITH RETURN PERIOD OF 200 YEARS.
 5. MATERIAL SPECIFICATIONS:
 FENCE PANEL: 0.35 BMT, G550 AM125 & COLORBOND
 FENCE POST: 0.8 BMT, G550 Z275 COLORBOND
 FENCE POST: 1.6 OR 2.5 BMT SHS GRADE 350LO GALVANISED.
 FENCE RAIL: 0.8 BMT, G550 Z 275 COLORBOND

Limitations
 1. THE DATA ON THIS SHEET SHALL BE APPLICABLE TO THE NEETASCREEN & SPANSCREEN FENCING ONLY.
 2. INSTALLATION SHALL BE IN ACCORDANCE WITH LYSAGHT FENCE - CYCLONIC AREA DESIGN & INSTALLATION GUIDE.

Accepted for Inclusion

DTCM ref: M/339/01

Chairman's Signature:

Chairman's Name: Paul Nowland

Date of Approval: 20/09/2019 Expiry Date: 20/09/2024

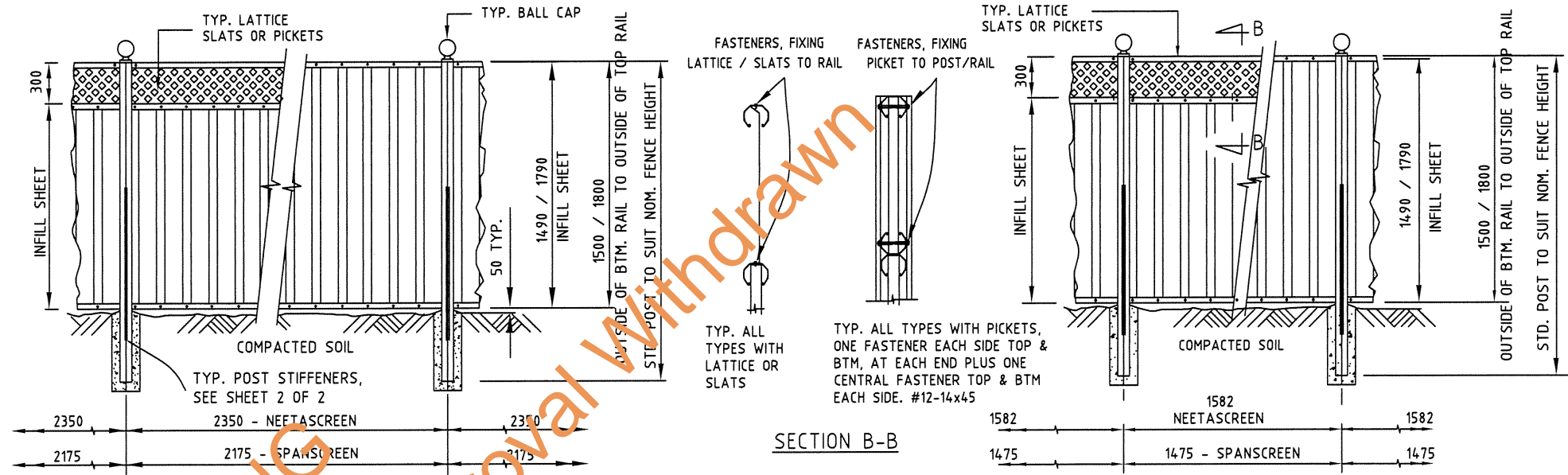

3 INFILL SHEET FENCE - WITH & WITHOUT LATTICE-SLATS-PICKETS
 REFER TABLE - 1 & FOOTING GA. REFER SHEET 2 OF 2 FOR LENGTH OF STIFFENER & EMBEDMENT DEPTH IN FOOTING

2 INFILL SHEET FENCE - WITH & WITHOUT LATTICE-SLATS-PICKETS
 REFER TABLE - 2 & FOOTING GA. REFER SHEET 2 OF 2 FOR LENGTH OF STIFFENER & EMBEDMENT DEPTH IN FOOTING

TABLE - 1

NOMINAL FENCE HEIGHT	WIND REGION		
	2	2.5	3
1500 OR 1800	CS3	FS3	FS3
	NS,SS - 0.35 BMT	NS,SS - 0.35 BMT	NS,SS - 0.35 BMT

TABLE - 3

NOMINAL FENCE HEIGHT	TERRAIN CATEGORY	FOOTING DEPTH FOR WIND REGION - C (TOP SOIL EXCLUDED)			
		SOFT CLAY, LOOSE SAND BEARING CAP. > 100 kpa		MEDIUM DENSE SAND & GRAVEL, STIFF CLAY BEARING CAP. > 200 kpa	
		2	3	2	3
1500 OR 1800	2	900	1100	500	700
	2.5	700	900	500	600
	3	500	700	500	500

TABLE - 2

NOMINAL FENCE HEIGHT	WIND REGION		
	C		
	2	2.5	3
1500 OR 1800	FS2	-	-
	NS,SS - 0.35 BMT	-	-

NS - NEETASCREEN, SS - SPANSCREEN
 FS - FLAT STIFFENER

TABLE 4 FASTENER SCHEDULE

CONNECTION	FENCE TYPE	FASTENER TYPE (CLASS 4)
ALL POST CAPS TO POST	ALL FENCE TYPES	1 / #10-6 X 16 EACH SIDE (2 - TOTAL)
ALL RAIL TO POST	ALL FENCE TYPES	1 / #10-16 X 16 EACH SIDE (2 - TOTAL) - LATTICE OR SLATS: 2 EXTRA PICKETS: SEE SECTION B-B
LATTICE-SLATS- TO RAIL	ALL FENCE TYPES	LATTICE-SLATS: 3 / #10-16 X 16, FOR EACH RAIL.
POST STIFFENER TO POST	ALL 'FS' TYPES	1800/1500 HIGH - 4 / #12- 24 X 32 SERIES 500
	TYPE 'CS' ONLY	1800 HIGH 6 / #12-24 X 32 SERIES 500 1500 HIGH 5 / #12-24 X 32 SERIES 500
POST TO POST	TYPE 'FS' ONLY	4 / #10-16 X 16
	TYPE 'CS' ONLY	2 / #10-16 X 16
POST TO SHS AT CORNERS	ALL FENCE TYPES	9 / #10-16 X 16 FOR EACH POST 1800 HIGH & 7 FOR 1500 HIGH
POST TO SHS BETWEEN CRNS	ALL FENCE TYPES	7 / #10-16 X 16 FOR EACH POST 1800 HIGH & 5 FOR 1500 HIGH
2 & 3 INFILL SHEETS TO RAILS	NS - 2 INFILL	9 / #12-14 X 45 THRU EVERY INFILL RIB FOR EACH RAIL - 3 INFILL USE 13 SCREWS
	SS - 2 INFILL	17 / #12-14 X 45 THRU EVERY INFILL RIB FOR EACH RAIL - 3 INFILL USE 25 SCREWS

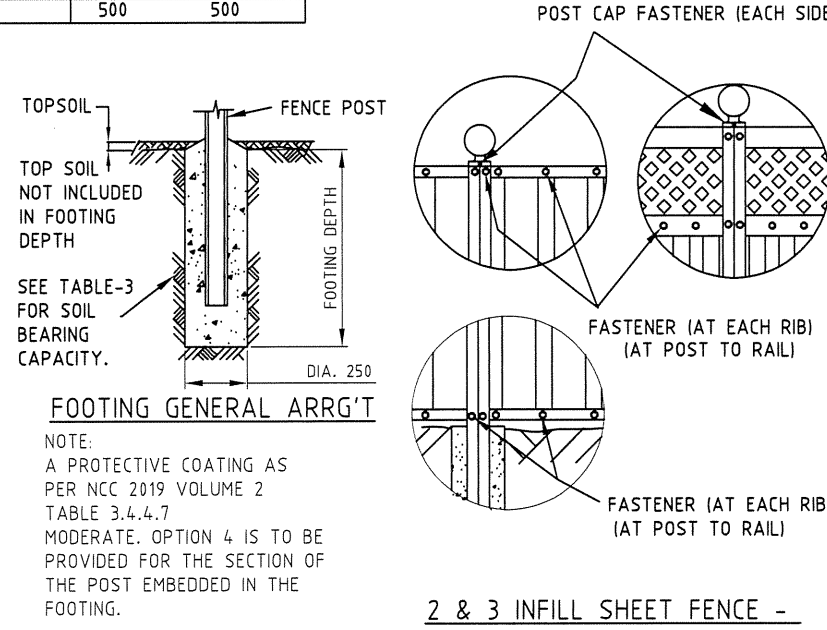

Notes covering basis of DTCM (Relevant test reports etc)
 1. INVESTIGATION OF EXTENDED RANGE FOR LYSAGHT FENCING REPORT 5.3 REPORT No 2 VERSION: 2. DATED JUNE 2012

*Checking Engineers Certification
 Name: KAVITHA MYSORE
 Registration Number: M. I. E. AUST. 2089547
 Date: 06/09/2019
 Signature:

*Certifying Engineers Certification
 Name: STEPHEN HEALEY
 NT Registration Number: 34856ES
 Date: 10/09/2019
 Signature:

*registered as a structural engineer in Australia *registered as a structural engineer in the Northern Territory

Product Name SHEET 2 OF 2
 FENCING FOR CYCLONIC REGIONS: NEETASCREEN & SPANSCREEN

Product Description
 FENCE PANEL: 0.35 BMT, G550 AM125 & COLORBOND
 FENCE POST: 0.8 BMT, G550 Z275 COLORBOND
 FENCE POST: 1.6 OR 2.5 BMT SHS GRADE 350LO GALVANISED.
 FENCE RAIL: 0.8 BMT, G550 Z 275 COLORBOND

Manufacturer's Name
Lysaght
 BlueScope Steel Limited
 A.B.N. 16 000 011 058
 Trading as Lysaght

Design Criteria
 1. FENCE CONFIGURATIONS ARE FOR TERRAIN CATEGORY 2, 2.5, & 3 IN WIND REGION 'C'. $VR = 61 \times F_c = 61 \times 1.05 = 64.1 \text{ m/sec.}$, CORRESPONDING TO AVERAGE RECURRENCE INTERVAL OF 200 YEARS.
 2. WIND LOADING ARE DERIVED FROM AS/NZS 1170.2: 2011 STRUCTURAL DESIGN ACTIONS PART 2: WIND ACTIONS BASED ON THE FOLLOWING PARAMETERS:
 a)

HEIGHT (mm)	TERRAIN / HEIGHT MULTIPLIER (M_z, cat)		
	TERRAIN CAT 2	TERRAIN CAT 2.5	TERRAIN CAT 3
≤ 1800	0.91	0.87	0.83

 b)

SHIELDING MULTIPLIER M_s	TERRAIN CAT 2	TERRAIN CAT 2.5	TERRAIN CAT 3
		0.95	0.85

 c) $M_t = 1.0$; TOPOGRAPHIC MULTIPLIER.
 d) $M_d = 1.0$; WIND DIRECTIONAL MULTIPLIER.
 REFER TO AS/NZS 1170.2 - 2011 FOR DESIGN OF FENCES INSTALLED NEAR RIDGES, HILLS OR ESCARPMENTS, OR WHERE SHIELDING CONDITION VARY.
 3. $C_{pn} = 1.2$ EXCEPT FOR TAPERED ENDS, REF. TO SECTION D2 - AS/NZS 1170.2:2011 STRUCTURAL DESIGN ACTIONS PART2: WIND ACTIONS.
 4. IMPORTANCE LEVEL 1, WITH RETURN PERIOD OF 200 YEARS.
 5. MATERIAL SPECIFICATIONS:
 FENCE PANEL: 0.35 BMT, G550 AM125 & COLORBOND
 FENCE POST: 0.8 BMT, G550 Z275 COLORBOND
 FENCE POST: 1.6 OR 2.5 BMT SHS GRADE 350LO GALVANISED.
 FENCE RAIL: 0.8 BMT, G550 Z 275 COLORBOND

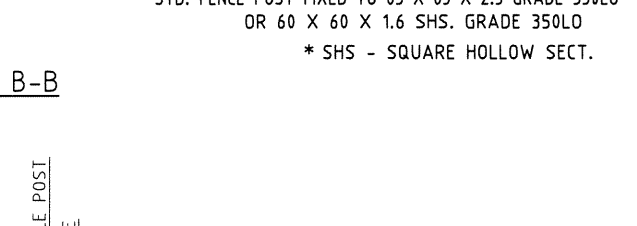
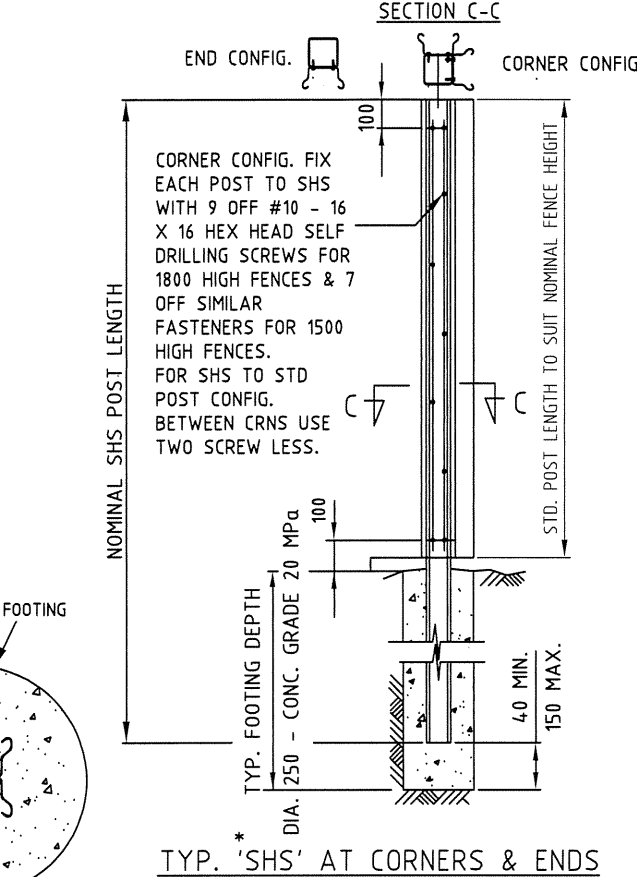
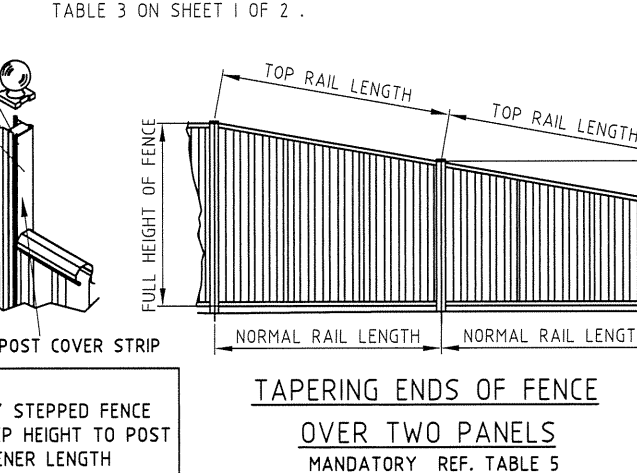
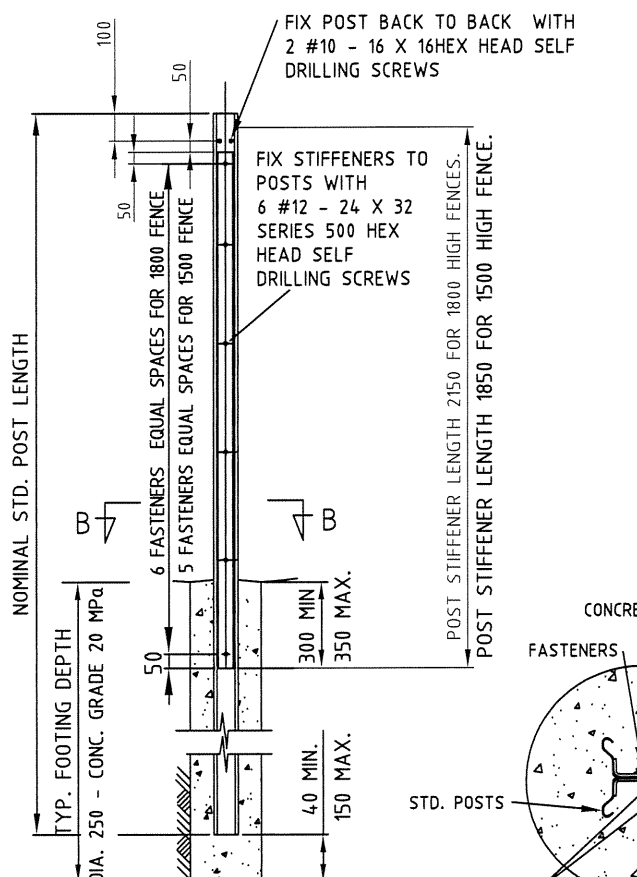
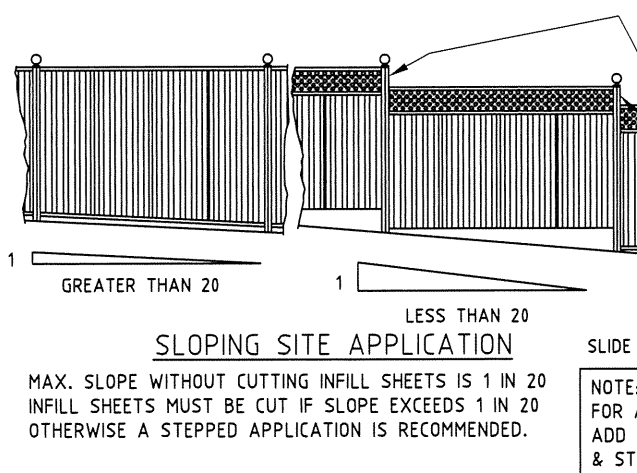
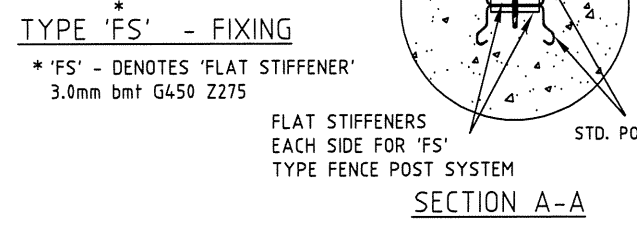
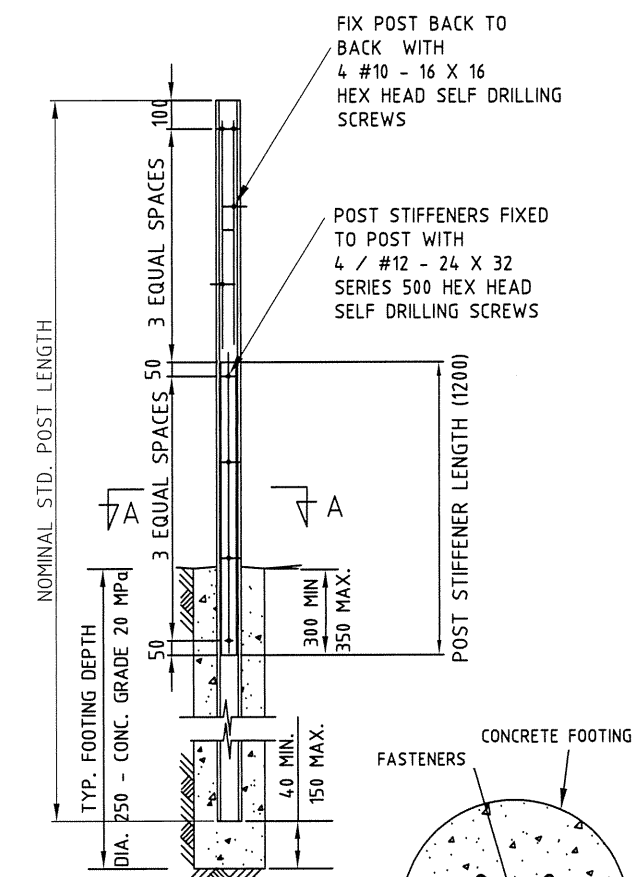

TABLE 5 - TAPERED FENCES

3 - INFILL SHEETS PER PANEL					
FENCE STYLE	HALF FENCE HEIGHT	HEIGHT OF MIDDLE POST	NORMAL RAIL LENGTH	TOP RAIL LENGTH	TOP RAIL LENGTH
1500 HIGH NEETASCREEN	750	1125	2350	2380	2380
1500 HIGH SPANSCREEN	750	1125	2175	2207	2207
1800 HIGH NEETASCREEN	900	1350	2350	2393	2393
1800 HIGH SPANSCREEN	900	1350	2175	2221	2221

2 - INFILL SHEETS PER PANEL					
FENCE STYLE	HALF FENCE HEIGHT	HEIGHT OF MIDDLE POST	NORMAL RAIL LENGTH	TOP RAIL LENGTH	TOP RAIL LENGTH
1500 HIGH NEETASCREEN	750	1125	1582	1626	1626
1500 HIGH SPANSCREEN	750	1125	1475	1522	1522
1800 HIGH NEETASCREEN	900	1350	1582	1645	1645
1800 HIGH SPANSCREEN	900	1350	1475	1542	1542

Limitations
 1. THE DATA ON THIS SHEET SHALL BE APPLICABLE TO THE NEETASCREEN & SPANSCREEN FENCING ONLY.
 2. INSTALLATION SHALL BE IN ACCORDANCE WITH LYSAGHT FENCE - CYCLONIC AREA DESIGN & INSTALLATION GUIDE.

Accepted for Inclusion
 DTCM ref: **M/339/01**

Notes covering basis of DTCM (Relevant test reports etc)
 1. INVESTIGATION OF EXTENDED RANGE FOR LYSAGHT FENCING REPORT 5.3 REPORT No 2 VERSION: 2. DATED JUNE 2012.

*Checking Engineers Certification
 Name: KAVITHA MYSORE
 Registration Number: M. I. E. AUST. 2089547
 Date: 06/09/2019
 Signature: *M.K. Kavitha*
*registered as a structural engineer in Australia

*Certifying Engineers Certification
 Name: STEPHEN HEALEY
 NT Registration Number: 34856ES
 Date: 10/09/2019
 Signature: *Stephen Healey*
*registered as a structural engineer in the Northern Territory

Chairman's Signature: *Paul Nowland*
 Chairman's Name: Paul Nowland
 Date of Approval: 20/09/2019 Expiry Date: 20/09/2024