

**NORTHERN TERRITORY DEEMED TO COMPLY MANUAL - National Construction Code Volume 2 (section 3.0.4 Structural resistance of materials in high wind areas.**  
 This product has been determined to satisfy NCC Performance Requirements P2.1.1 for structural stability and resistance

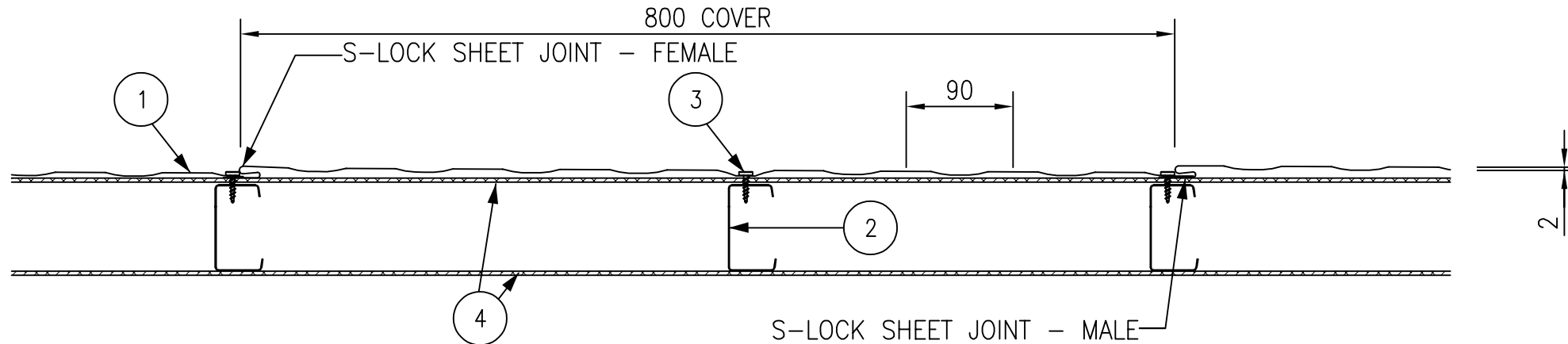

Standard Mesa Profile Cladding 0.4mm BMT G300 Grade (1)  
 Cold Rolled Engineered Wall Frame (Studs, Top & Bottom Plates, Nogs) 0.75mm BMT G550 Grade (2)  
 fixed together with 6-12 steel rivets 1010 Grade  
 Mesa Cladding (1) fixed to Cold Rolled Engineered Wall Frame (2) with Class 4 screw type A, B, C, D (3);  
 Screws to be valley fixed

Fixing of external cladding at 400mm centres on studs and 300mm centres on wall perimeter and around door and window openings.  
 Screw Type:

- A 15-15x25mm HEX HEAD
- B 10-16x30mm WAFER HEAD
- C 10-16x25mm HEX HEAD
- D 10-24x22mm WAFER HEAD

The S-lock 'Female' shall be screwed at 400mm centres to the stud after insertion of the leading edge of the following sheet.  
 Note: the Mesa cladding shall NOT be considered to provide design resistance to in-plane (racking) forces

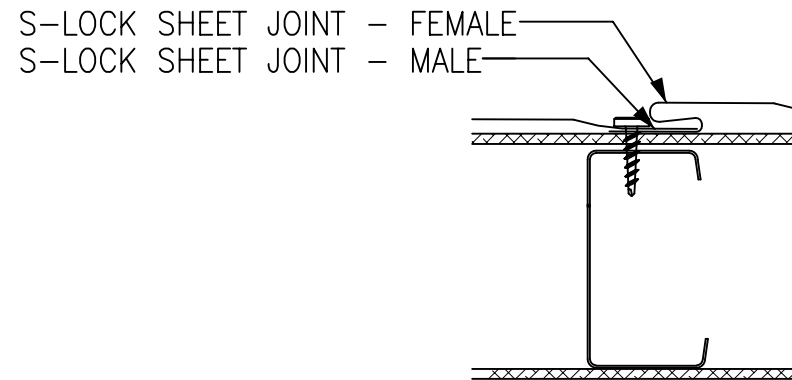

**Product Name** Mesa Wall Cladding for Ausco Modular Transportable Buildings (Cyclonic Areas - Region C)

**Product Description** Standard Mesa Profile Cladding 0.4mm BMT G300 Grade

**Manufacturer's Name** Ausco Modular Pty Ltd

**Design Criteria**  
 In accordance with AS/NZS 1170.2:2011 "Structural design actions - Wind Actions"

Building Importance Level (BCA Table B1.2a): 2  
 Annual Probability of Exceedance for (BCA Table 1.2b): 1 in 50

Region: C Regional ultimate wind speed  $V_R$ (m/s): 69  
 Terrain Category 1 or 2 Reference height (m): 4

$M_{Z,CAT}$  1.02 (TC1), 0.91 (TC2)  $M_S$ : 1  $M_T$ : 1

$V_{DES0}$  Design Wind Speed at reference height (m/s): 70 (TC1), 63 (TC2)

Internal Pressure Coefficients ( $C_{pi}$ ): +0.7, -0.65

External Pressure Coefficients ( $C_{pe}$ ) Walls +0.7, -0.65  
 Roof N/A

Net Pressure Coefficients: ( $C_{p,n}$ ) Roof/Walls N/A

Imposed Loads, kPa Floor / Roof N/A

**Limitations**  
 Building height  $\leq 4m$  Region 'C'  
 Internal lining (4) including fixing to be adequate to resist design positive and negative wind pressures.

**Accepted for Inclusion**

DTCM ref: M/216/01

Chairman's Signature:

Chairman's Name: Paul Nowland

Date of Approval: 19/10/2021 Expiry Date: 19/10/2026

Notes covering basis of DTC (Relevant test reports etc)

**Ausco Modular Pty Ltd Test Report Number 0088, July 2004**  
 This certificate relates only to Mesa cladding manufactured by Ausco Modular Pty Ltd

\*Checking Engineers Certification

Name: TIM PETERS  
 Rego Number: 18257ES  
 Date: 29/07/21  
 Signature:

\*registered as a structural engineer in Australia

\*Certifying Engineers Certification

Name: Nicholas Murphy  
 NT Rego Number: 132328ES  
 Date: 13.09.2021  
 Signature:

\*registered as a structural engineer in Northern Territory