

TESTING CRITERIA

THE MASTERBILT FIRE/CYCLONE SHELTER DOOR ASSEMBLY SHOWN ON THIS DESIGN DATA SHEET IS BASED ON A PROTOTYPE WHICH HAS BEEN SUCCESSFULLY TESTED :-

- 1) AS A 1, 2 AND OR 3 HR FIRE RESISTANCE RATING FIRE DOOR ASSEMBLY IN TERMS OF A.S.A. 30.1958. TEST CONDUCTED BY AN APPROVED TESTING AUTHORITY AT RYDE, NEW SOUTH WALES AND,
 - 2) AS A CYCLONE SHELTER DOOR ASSEMBLY IN TERMS OF CLAUSE 5317 OF THE N.T. BUILDING MANUAL, 1975.
- THE IMPACT TEST (8 KG X 30m/sec) WAS CONDUCTED BY THE C.S.I.R.O. HIGHTT VICTORIA ON THE 5th SEPT, 1975.

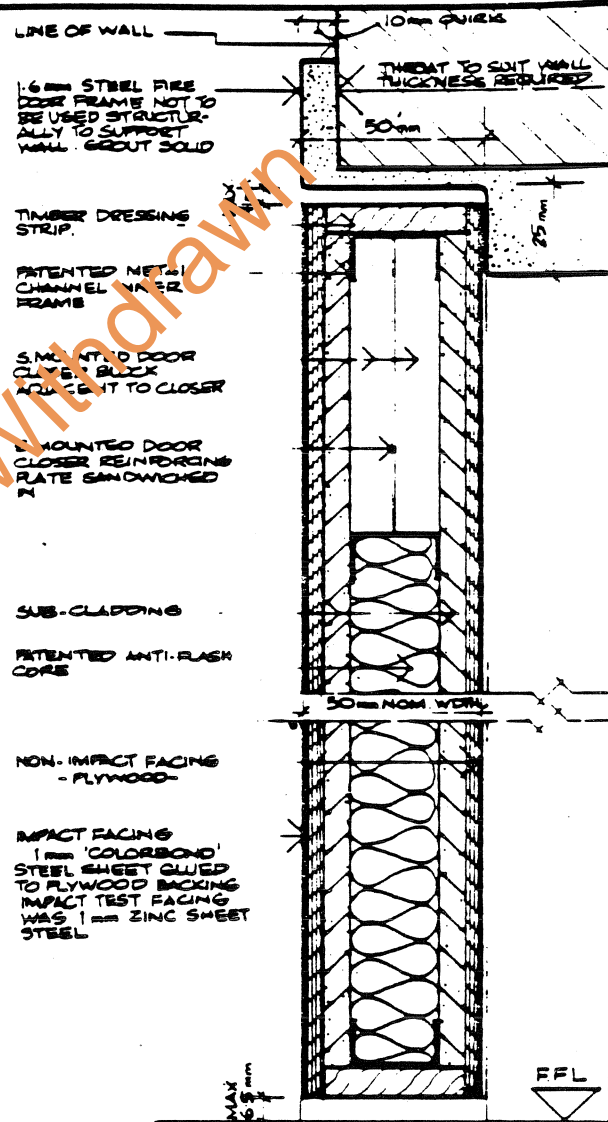
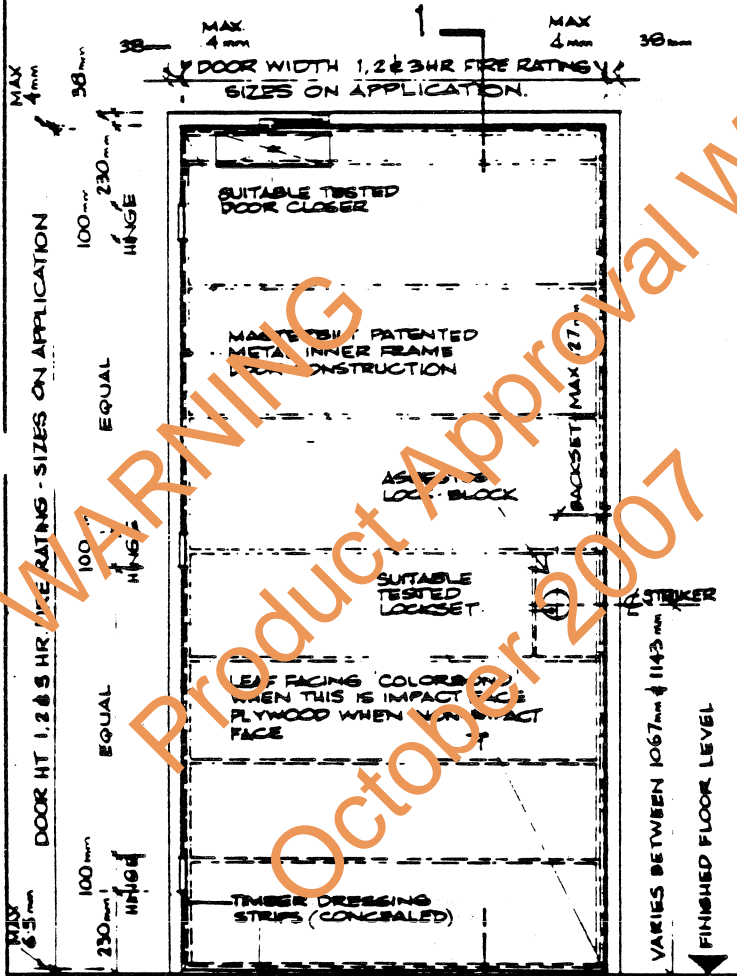

1:1 TYPICAL SECTION DETAIL SCALE 1:2

ELEVATION DETAIL NOTE: TO COMPLY WITH AS 1537.1-1972 - FIRE DOOR CODE EACH ASSEMBLY MUST INCLUDE A LOCKSET & DOOR CLOSER, A DOOR, HINGES, FRAME, AND BUILDING IN DETAILS AS PER TESTED PROTOTYPE

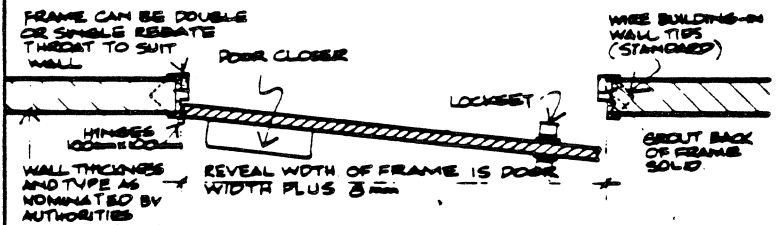

PLAN DETAIL AT OPENING NOTE: ANY FACE CAN BE NOMINATED AS THE IMPACT FACE TO RECEIVE 'COLORBOND' FACING MATERIAL. SCALE 1:20

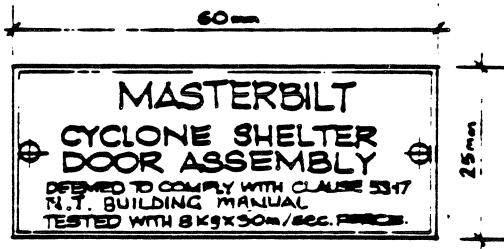

SUGGESTED LABELLING OF CYCLONE SHELTER DOORS

LABEL SHOWN FULL SIZE. SUGGEST MECHANICAL FIXING ON LEADING STILL EDGE OF DOOR LEAF AT APPROX 1520mm ON SATISFACTORY COMPLETION OF INSTALLATION. ALL LETTERING SHOULD BE RAISED. NO LETTERS SHOULD BE LESS THAN 1.5mm HIGH.

MANUF'S NAME:
MASTERBILT INDUSTRIES (AUSTRALIA) PTY. LTD
ADDRESS:
59 NORMANBY ROAD NOTTINGHILL
VIC 3168 TEL: (03) 543 2888

FIXING OF MASTERBILT FIRE/CYCLONE SHELTER DOOR ASSEMBLY.

CERTIFIED:
[Signature] M.I.E. AUST
DATE 5/9/75

DESIGN DATA SHEET 1/1

NORTHERN TERRITORY CYCLANIC AREAS

DWG NO
M/401/FD1
DATE: 16/9/75

DATE 12.10.78